

## LOW FREQUENCY SPLIT PHASE SOLAR INVERTER PV3600 TLV Series

8~12KW | 245V | 100A, 200A

PV3600 TLV series is a multi-function inverter ,combining functions of inverter and MPPT solar charge controller, solar charger and battery charger to offer uninterruptible power support. The comprehensive LCD display offers user-configurable and easy-accessible button operation such as battery charging current, AC/solar charger priority, and selectable input voltage based on different applications.



- Smart LCD setting(Working modes, Charge Current, Charge voltage, etc.)
- Built-in MPPT solar charge controller 100A/200A
- MPPT efficiency max 98%
- Powerful charge rate up to 140Amp
- Inside BMS function
- DC start &Automatic Self-Diagnostic Function
- WIFI / USB monitoring function (wi-fi optional)
- Supporting AGS, BTS port
- Compatible to generator



### Back panel description

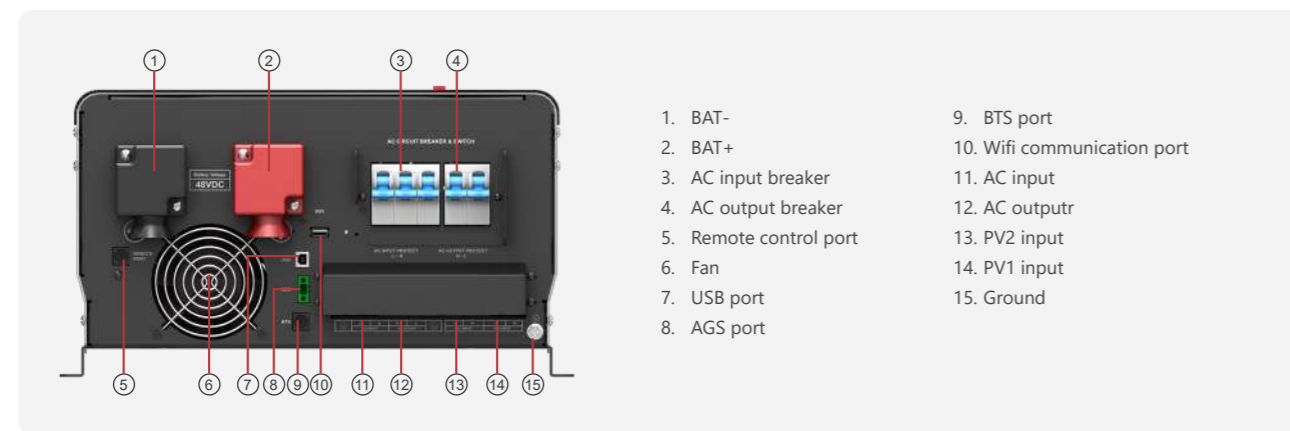

### Solar system connection

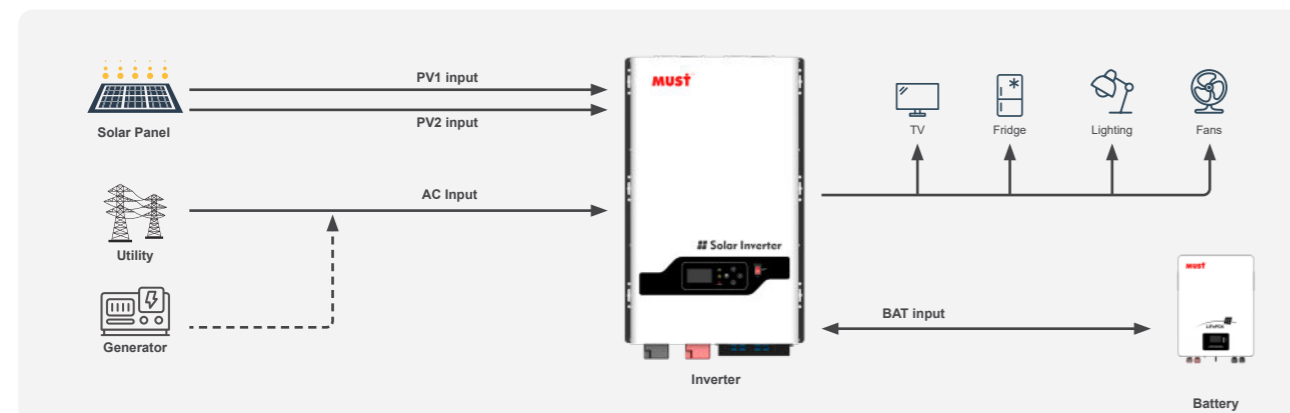

MODEL	PV36-8048 TLV	PV36-10048 TLV	PV36-12048 TLV
Nominal Battery System Voltage	48VDC	48VDC	48VDC
<b>INVERTER OUTPUT</b>			
Rated power	8.0KW	10.0KW	12.0KW
Surge rating	24000VA	30000VA	36000VA
Capable of starting electric motor	4HP	5HP	6HP
Waveform	Pure sine wave / same as input (bypass mode)		
Nominal output voltage RMS	100V/110V/120V/200V/220V/240V		
Output frequency	50Hz / 60Hz ± 0.3Hz		
Inverter efficiency(peak)	>88%		
Line mode efficiency	>95%		
Power factor	1.0		
Typical transfer time	20ms(max)		
<b>AC INPUT</b>			
Voltage	220V/230V/240V		
Selectable voltage range	90-280 VAC (APL)		
Frequency range	50Hz / 60Hz		
<b>BATTERY</b>			
Low battery voltage cutoff	40-48VDC for 48VDC mode		
Low battery voltage recover	42-50VDC for 48VDC mode		
High battery voltage cutoff	60VDC for 48VDC mode		
High battery voltage recover	57VDC for 48VDC mode		
Power saving mode	<600W		
<b>AC CHARGER</b>			
Output voltage	Depends on battery type		
Charger AC input breaker rating	80A	80A	80A
Overcharge protection S.D.	62.8VDC for 48VDC mode		
Maximum charge current	60A	70A	80A
<b>BTS</b>			
Continuous output power	Yes Variances in charging voltage & S.D. voltage base on the battery temperature		
<b>BYPASS &amp; PROTECTION</b>			
Input voltage waveform	Sine wave (grid or generator)		
Nominal input frequency	50Hz or 60Hz		
Overload protection (SMPS Load)	Circuit breaker		
Output short circuit protection	Circuit breaker		
Bypass breaker rating	63A	63A	63A
Max bypass current	80A		
<b>SOLAR CHARGER</b>			
Maximum PV charge current	100A/200A		
DC voltage	48V		
Maximim PV array power	5000W(10000W for 200A optional)		
MPPT range @ operating voltage(VDC)	64~235VDC		
Maximum PV array open circuit voltage	250VDC		
Maximum efficiency	>98%		
Standby power consumption	<2W		
<b>MECHANICAL SPECIFICATIONS</b>			
Mounting	Wall mount		
Machine Dimension (W*H*D)(mm)	402*674*222		
Package Dimension (W*H*D)(mm)	818*415*577.5		
N.W(kg)	/		
G.W(kg)	/		
<b>OTHER</b>			
Operation temperature range	0°C to 50°C		
Storage temperature	-15°C to 60°C		
Audible noise	60dB MAX		
Display	LED+LCD		
Standard Warranty	2years		
<b>CERTIFICATION &amp; STANDARDS</b>			
CE-LVD (IEC62109-1:2010, EN IEC62109-2:2011)			

\*The technical specifications of this document are subject to change without any notice